

Typical Electrical-Optical Characteristics at Ta = 25°C, IF=20mA

Part No.	Size	Viewing Angle(deg)	Package Type	Emitting Color	Dominant Wavelength (nm)	Luminous Intensity (mcd)		Forward Voltage(V)	
						Min.	Typ.	Typ.	Max.
RC-L503RCA0-XX	4.8mm	70-180	Round	Red	618-630	100	500	2.0	2.4
RC-L503YCA0-XX	4.8mm	70-180	Round	Yellow	580-593	100	500	2.0	2.4
RC-L504GCA0-XX	4.8mm	70-180	Round	Green	510-530	300	2000	3.2	3.6
RC-L504BCA0-XX	4.8mm	70-180	Round	Blue	450-480	100	500	3.2	3.6
RC-L504PCA0-XX	4.8mm	70-180	Round	Purel	360-420	10	50	3.4	3.8
RC-L504WCA0-XX	4.8mm	70-100	Round	White		800	2500	3.2	3.6

Outline Dimension(mm)

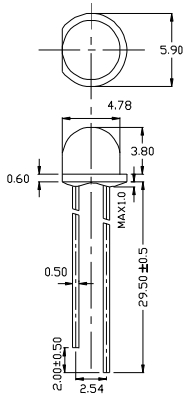

Optical-Electrical Characteristics

